

Entlüftungsstutzen Messing	Venting connection nickel-plated brass	160
Richtungsfeststeller Messing	Adjustable fixing device nickel-plated brass	161
Gegenmuttern Messing	Lock nuts nickel-plated brass	162
Gegenmuttern Messing dicke Ausführung	Lock nuts nickel-plated brass thick-walled version	163
Gegenmuttern Messing mit Hinterstich für O-Ring	Fixing lock nut nickel-plated brass with recess for o-ring	163
EMV-Gegenmuttern Messing mit Schneidezähnen	EMC lock nut nickel-plated brass with cutting teeth for optimised shield contact	164
Reduktionsflansche Messing	Reduction fittings nickel-plated brass	165 - 168
Reduktionen Messing	Reduction fittings nickel-plated brass	169
Erweiterungen Messing	Enlarging fittings nickel-plated brass	170 - 173
Verschlusschrauben Messing	Locking plug nickel-plated brass	174 - 175
Erdungslaschen Messing zu Kabelverschraubungen	Grounding strap suitable for cable glands	176
Gegenmuttern Stahl rostfrei A2/A4	Steel lock nuts stainless steel A2/A4	176 - 177
Verschlusschrauben Stahl rostfrei A2	Steel locking plugs stainless steel A2	178 - 179
Gegenmuttern Kunststoff	Synthetic lock nuts	180
Gegenmuttern Kunststoff mit Flansch	Synthetic lock nut with flange	181
Erweiterungen Kunststoff	Synthetic enlarging fittings	182 - 183
Reduktionsflansche Kunststoff	Synthetic reduction fittings	184 - 185
Verschlusschrauben Kunststoff	Synthetic locking plug	186
Dichtungseinsätze Vollgummi	Solid rubber sealing inserts	187
O-Ringe NBR, FPM, Dichtungsscheiben	O-rings NBR, FPM, sealing washers	188 - 190
Blindscheiben, Verschlussbolzen, Einschnittringe	Blind discs, locking pins, sealing rings	190 - 191
Spezialwerkzeug	Special tool	191

Entlüftungsstutzen Messing

Venting connection nickel-plated brass

Anschlussgewinde metrisch

Entry thread metric

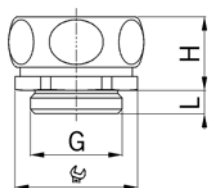

Material: Messing vernickelt
 Filterscheibe: Sinterbronze
 O-Ring : Separat bestellen
 Einsatztemperatur: -50°C / +200°C
 Filtergrad: 4 , Filterfeinheit 0,05-0,075
 Eigenschaften: Die Filterscheibe ist spritzwasser- und insektensicher

Material: Nickel-plated brass
 Filter disc: Sintered bronze
 O-ring : To be ordered separately
 Temperature range: 4, filter fineness 0,05-0,075
 Degree of filter: The filter disc is splash-proof and insect-proof
 Properties:

Anschlussgewinde metrisch

Entry thread metric

ohne O-Ring

without O-Ring



Art.-Nr.	G	$\frac{H}{L}$ mm	H mm	L mm	O-ring	
2117.928	M16x1.5	23/25	17	10	1000.09.00.08	25
2120.928	M20x1.5	27/29	18	10	2111.00.08	25
2125.928	M25x1.5	34/36	23	11	1013.00.22.08	25
2132.928	M32x1.5	43/45	24	13	1021.00.08	25

Anschlussgewinde Pg

Entry thread Pg



Anschlussgewinde Pg

Entry thread Pg

ohne O-Ring

without O-Ring

Art.-Nr.	G	$\frac{H}{L}$ mm	H mm	L mm	O-ring	
2111.928	Pg 11	23/25	17	7	2111.00.08	50
2116.928	Pg 16	27/29	20	7	1016.00.08	50
2121.928	Pg 21	34/36	23	7.5	1016.00.25.08	25

Richtungsfeststeller Messing

Anschlussgewinde metrisch

Adjustable fixing device nickel-plated brass

Entry thread metric

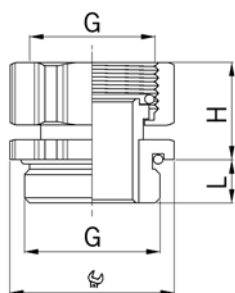

Material: Messing vernickelt
 O-Ring : 2 x NBR
 Einsatztemperatur: -20°C / +100°C
 Schutzart: IP 68
 Einsatzbereich: Besonders geeignet für die richtungsstabile Montage von Winkeln

Material: Nickel-plated brass
 O-ring : 2 x NBR
 Temperature range: -20°C / +100°C
 Protection class: IP 68
 Application: Suitable for directionally stable mounting of elbows



Anschlussgewinde metrisch

Entry thread metric

mit O-Ring

with O-ring



Art.-Nr.	G	 mm	H mm	L mm	
5000.17.50	M16x1.5	18	14	6	50
5000.20.50	M20x1.5	22	14	6	50
5000.25.50	M25x1.5	28	15	7	50
5000.32.50	M32x1.5	35	18	8	50

Anschlussgewinde Pg

Entry thread Pg



Anschlussgewinde Pg

Entry thread Pg

mit O-Ring

with O-ring



Art.-Nr.	G	 mm	H mm	L mm	
5009.50	Pg 9	17	14	6	50
5011.50	Pg 11	20	14	6	50
5013.50	Pg 13	22	14	6	50
5016.50	Pg 16	24	16	6	50
5021.50	Pg 21	30	18	7	25
5029.50	Pg 29	40	19	8	25

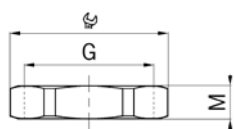



Material: Messing vernickelt
 Ausführung: 6-kant
 Einsatztemperatur: -40°C / +200°C

Material: Nickel-plated brass
 Execution: Hexagonal design
 Temperature range: -40°C / +200°C

Gewinde metrisch

Metric thread





Art.-Nr.	G	 mm	M mm	
8000.06.1	M 6x0.75	9	2.8	50
8000.06	M 6x1.0 ¹⁾	9	2.8	50
8000.08.1	M 8x1.0	11	2.8	50
8000.08	M 8x1.25 ¹⁾	11	2.8	50
8000.10.1	M10x1.0	13	2.8	50
8000.10	M10x1.5 ¹⁾	13	2.8	50
8000.12	M12x1.5	15	3.0	100
8000.17	M16x1.5	19	3.0	100
8000.20	M20x1.5	24	3.5	100
8000.25	M25x1.5	30	4.0	50
8000.32	M32x1.5	36	4.0	25
8000.40	M40x1.5	46	5.0	25
8000.50	M50x1.5	55	5.5	10
8000.63	M63x1.5	70	6.0	10
8000.75	M75x1.5	80	6.0	10
8000.085	M85x2.0	95	8.0	5
8000.095	M95x2.0	110	9.0	5
8000.100	M100x3.0	115	9.0	1
8000.105	M105x3.0	120	9.0	1
8000.115	M115x3.0	125	10.0	1

1) Metrisches Regelgewinde

1) Metric coarse-pitch thread



Gewinde Pg

Pg thread

Art.-Nr.	G	 mm	M mm	
8007	Pg 7	15	3.0	50
8009	Pg 9	18	3.0	50
8011	Pg 11	21	3.0	50
8013	Pg 13	23	3.0	50
8016	Pg 16	26	3.0	50
8021	Pg 21	32	3.5	25
8029	Pg 29	41	4.0	10
8036	Pg 36	51	5.0	10
8042	Pg 42	60	5.0	10
8048.48	Pg 48	64	5.5	10

Gasrohr-Gewinde

Gas-pipe thread

Art.-Nr.	G	 mm	M mm	
803/8G	G3/8"	19	3.0	10
801/2G	G1/2"	24	3.0	10
805/8G	G5/8"	26	3.0	10
803/4G	G3/4"	30	3.5	10
801G	G 1"	38	4.5	10
8011/2G	G 1 1/2"	51	5.0	10
8011/4G	G 1 1/4"	46	5.0	10
8048	G 2"	64	5.5	10

Gegenmuttern Messing dicke Ausführung

Lock nuts nickel-plated brass thick-walled version

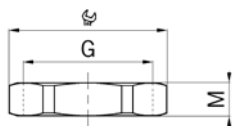

Material: Messing vernickelt
Ausführung: 6-kant
Einsatztemperatur: -40°C / +200°C

Material: Nickel-plated brass
Execution: Hexagonal design
Temperature range: -40°C / +200°C

Gewinde metrisch Dicke Ausführung

Metric thread Thick-walled version

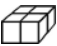
Art.-Nr.	G	 mm	M mm	
8300.12	M12x1.5	15	5.0	50
8300.17	M16x1.5	19	5.0	50
8300.20	M20x1.5	24	5.5	50
8300.25	M25x1.5	30	5.5	50
8300.32	M32x1.5	36	6.0	50
8300.40	M40x1.5	46	7.0	50



Gewinde Pg Dicke Ausführung

Pg thread Thick-walled version

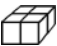
Art.-Nr.	G	 mm	M mm	
8300.07	Pg 7	15	5.0	50
8300.09	Pg 9	18	5.0	50
8300.11	Pg 11	21	5.0	50
8300.13	Pg 13	24	5.5	50
8300.16	Pg 16	26	5.5	50
8300.21	Pg 21	32	6.0	50
8300.29	Pg 29	41	7.0	50

Gegenmuttern Messing mit Hinterstich für O-Ring

Fixing lock nut nickel-plated brass with recess for o-ring

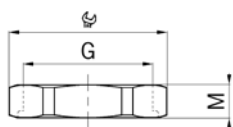

Material: Messing vernickelt
Ausführung: 6-kant
O-Ring : Separat bestellen
Einsatztemperatur: -40°C / +200°C

Material: Nickel-plated brass
Execution: Hexagonal design
O-ring : To be ordered separately
Temperature range: -40°C / +200°C

Gewinde metrisch Dicke Ausführung

Metric thread Thick-walled version

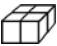
Art.-Nr.	G	 mm	M mm	O-ring	
8300.12.1	M12x1.5	15	5.0	1007.00.08	50
8300.17.1	M16x1.5	19	5.0	1016.00.15.08	50
8300.20.1	M20x1.5	24	5.5	1016.00.08	50
8300.25.1	M25x1.5	30	5.5	1013.00.22.08	50
8300.32.1	M32x1.5	36	6.0	1021.00.30.08	50
8300.40.1	M40x1.5	46	7.0	1029.00.39.08	50
8300.50.1	M50x1.5	55	7.5	1036.00.49.08	10
8300.63.1	M63x1.5	70	8.0	1048.00.62.08	10



EMV-Gegenmuttern Messing mit Schneidezähnen

EMC lock nut nickel-plated brass with cutting teeth

Anschlussgewinde metrisch

Entry thread metric

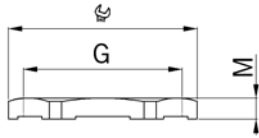

Material: Messing vernickelt
 Ausführung: 6-kant
 Einsatztemperatur: -40°C / +200°C

Material: Nickel-plated brass
 Execution: Hexagonal design
 Temperature range: -40°C / +200°C

Gewinde metrisch

Metric thread



Art.-Nr.	G	mm	M mm	
8008.85	M 8x1.25 ¹⁾	11	3.3	25
8010.85	M10x1.5 ¹⁾	13	3.3	25
8012.85	M12x1.5	15	3.5	25
8017.85	M16x1.5	19	3.5	25
8020.85	M20x1.5	24	4.0	25
8025.85	M25x1.5	30	4.0	10
8032.85	M32x1.5	36	5.0	10
8040.85	M40x1.5	46	5.3	10
8050.85	M50x1.5	55	6.3	10
8063.85	M63x1.5	70	7.0	10

1) Metrisches Regelgewinde

1) Metric coarse-pitch thread

Anschlussgewinde Pg

Entry thread Pg



Gewinde Pg

Pg thread

Art.-Nr.	G	mm	M mm	
8007.85	Pg 7	15	3.3	25
8009.85	Pg 9	18	3.3	25
8011.85	Pg 11	21	3.5	25
8013.85	Pg 13	24	3.5	25
8016.85	Pg 16	26	3.5	25
8021.85	Pg 21	32	4.0	10
8029.85	Pg 29	41	4.6	10
8036.85	Pg 36	50	5.8	10
8042.85	Pg 42	60	5.8	10
8048.85	Pg 48	64	6.5	10

Reduktionsflansche Messing

mit 6-kant

Reduction fittings nickel-plated brass

hexagonal

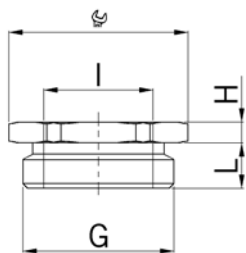

Material: Messing vernickelt
 O-Ring : NBR
 Einsatztemperatur: -40°C / +100°C
 Schutzart: IP 68

Material: Nickel-plated brass
 O-ring : NBR
 Temperature range: -40°C / +100°C
 Protection class: IP 68



Aussengewinde metrisch
Innengewinde metrisch
 mit O-Ring

Outer thread metric
Inner thread metric
 with O-ring

Art.-Nr.	G	I	Ø mm	H mm	L mm	
3500.08.06	M 8x1.25 ¹⁾	M 6x1.0 ¹⁾	11	8.0	5	50
3500.10.06	M10x1.5 ¹⁾	M 6x1.0 ¹⁾	13	3.0	5	50
3500.10.08	M10x1.5 ¹⁾	M 8x1.25 ¹⁾	13	8.0	5	50
3500.12.08	M12x1.5	M 8x1.25 ¹⁾	15	3.0	5	50
3500.12.10	M12x1.5	M10x1.5 ¹⁾	15	8.0	5	50
3500.17.10	M16x1.5	M10x1.5 ¹⁾	18	3.0	5	50
3500.17.12	M16x1.5	M12x1.5	18	3.0	5	50
3500.20.12	M20x1.5	M12x1.5	24	3.0	6	50
3500.20.17	M20x1.5	M16x1.5	24	3.0	6	50
3500.25.17	M25x1.5	M16x1.5	30	3.5	7	25
3500.25.20	M25x1.5	M20x1.5	30	3.5	7	25
3500.32.20	M32x1.5	M20x1.5	36	4.0	8	20
3500.32.25	M32x1.5	M25x1.5	36	4.0	8	20
3500.40.25	M40x1.5	M25x1.5	46	4.5	8	10
3500.40.32	M40x1.5	M32x1.5	46	4.5	8	10
3500.50.32	M50x1.5	M32x1.5	55	5.0	9	10
3500.50.40	M50x1.5	M40x1.5	55	5.0	9	10
3500.63.40	M63x1.5	M40x1.5	70	5.5	10	5
3500.63.50	M63x1.5	M50x1.5	70	5.5	10	5
3500.75.50	M75x1.5	M50x1.5	80	6.0	11	5
3500.75.63	M75x1.5	M63x1.5	80	6.0	11	5

1) Metrisches Regelgewinde

1) Metric coarse-pitch thread

Aussengewinde metrisch
Innengewinde Pg
 mit O-Ring

Outer thread metric
Inner thread Pg
 with O-ring

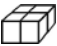
Art.-Nr.	G	I	Ø mm	H mm	L mm	
3500.17.07	M16x1.5	Pg 7	20	3.0	7	50
3500.20.07	M20x1.5	Pg 7	24	3.0	7	50
3500.20.09	M20x1.5	Pg 9	24	3.0	7	50
3500.20.11	M20x1.5	Pg 11	24	13.0	7	50
3500.25.09	M25x1.5	Pg 9	30	3.5	8	50
3500.25.11	M25x1.5	Pg 11	30	3.5	8	50
3500.25.13	M25x1.5	Pg 13	30	3.8	8	50
3500.25.16	M25x1.5	Pg 16	30	15.0	8	25
3500.32.21	M32x1.5	Pg 21	38	16.0	8	25
3500.40.29	M40x1.5	Pg 29	45	16.0	8	10
3500.50.29	M50x1.5	Pg 29	55	4.0	10	10
3500.63.36	M63x1.5	Pg 36	70	5.5	11	10

Reduktionsflansche Messing

mit 6-kant

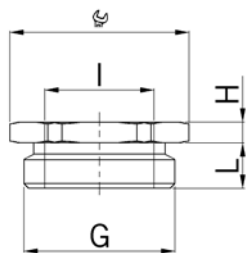

Material: Messing vernickelt
 O-Ring : NBR
 Einsatztemperatur: -40°C / +100°C
 Schutzart: IP 68

Reduction fittings nickel-plated brass

hexagonal

Material: Nickel-plated brass
 O-ring : NBR
 Temperature range: -40°C / +100°C
 Protection class: IP 68



Aussengewinde Pg
Innengewinde metrisch
 mit O-Ring

Outer thread Pg
Inner thread metric
 with O-ring

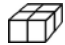
Art.-Nr.	G	I	$\frac{H}{mm}$	$\frac{H}{mm}$	$\frac{L}{mm}$	
3500.07.06	Pg 7	M 6x1.0 ¹⁾	15	3.0	6	50
3500.07.08	Pg 7	M 8x1.25 ¹⁾	15	3.0	6	50
3500.07.10	Pg 7	M10x1.5 ¹⁾	15	7.0	6	50
3500.09.06	Pg 9	M 6x1.0 ¹⁾	18	3.0	6	50
3500.09.08	Pg 9	M 8x1.25 ¹⁾	18	3.0	6	50
3500.09.10	Pg 9	M10x1.5 ¹⁾	18	3.0	6	50
3500.09.12	Pg 9	M12x1.5	18	8.0	6	50
3500.11.06	Pg 11	M 6x1.0 ¹⁾	21	3.0	6	50
3500.11.08	Pg 11	M 8x1.25 ¹⁾	21	3.0	6	50
3500.11.10	Pg 11	M10x1.5 ¹⁾	21	3.0	6	50
3500.11.12	Pg 11	M12x1.5	21	3.0	6	50
3500.11.17	Pg 11	M16x1.5	21	8.0	6	50
3500.13.12	Pg 13	M12x1.5	24	3.0	6	50
3500.13.17	Pg 13	M16x1.5	24	3.0	6	50
3500.16.12	Pg 16	M12x1.5	24	3.0	6	25
3500.16.17	Pg 16	M16x1.5	24	3.0	6	25
3500.16.20	Pg 16	M20x1.5	24	10.5	6	25
3500.21.17	Pg 21	M16x1.5	30	3.5	7.5	25
3500.21.20	Pg 21	M20x1.5	30	3.5	7.5	25
3500.21.25	Pg 21	M25x1.5	30	10.5	7.5	25
3500.29.25	Pg 29	M25x1.5	38	4.0	8	20
3500.29.32	Pg 29	M32x1.5	38	13.0	8	20
3500.36.32	Pg 36	M32x1.5	50	4.5	8	10
3500.36.40	Pg 36	M40x1.5	50	4.5	8	10
3500.42.32	Pg 42	M32x1.5	55	5.0	10	10
3500.42.40	Pg 42	M40x1.5	55	5.0	10	10
3500.42.50	Pg 42	M50x1.5	55	15.0	10	10
3500.48.40	Pg 48	M40x1.5	65	5.5	11	5
3500.48.50	Pg 48	M50x1.5	65	5.5	11	5

1) Metrisches Regelgewinde

1) Metric coarse-pitch thread

Reduktionsflansche Messing

mit 6-kant

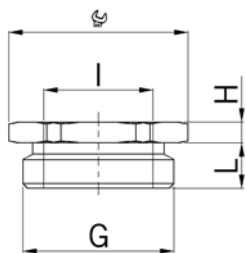

Material: Messing vernickelt
 O-Ring : NBR
 Einsatztemperatur: -40°C / +100°C
 Schutzart: IP 68

Reduction fittings nickel-plated brass

hexagonal

Material: Nickel-plated brass
 O-ring : NBR
 Temperature range: -40°C / +100°C
 Protection class: IP 68



Aussengewinde Pg
Innengewinde Pg
 mit O-Ring

Outer thread Pg
Inner thread Pg
 with O-ring

Art.-Nr.	G	I	G mm	H mm	L mm	
3509.07	Pg 9	Pg 7	18	3.0	6.5	50
3511.07	Pg 11	Pg 7	20	3.0	6.5	50
3511.09	Pg 11	Pg 9	22	3.0	7.0	50
3513.07	Pg 13	Pg 7	24	3.0	7.0	50
3513.09	Pg 13	Pg 9	24	3.0	7.0	50
3513.11	Pg 13	Pg 11	24	3.0	7.0	50
3516.09	Pg 16	Pg 9	24	3.0	7.0	50
3516.11	Pg 16	Pg 11	24	3.0	7.0	50
3516.13	Pg 16	Pg 13	27	3.0	7.0	50
3521.11	Pg 21	Pg 11	32	3.5	7.5	25
3521.13	Pg 21	Pg 13	32	3.5	7.5	25
3521.16	Pg 21	Pg 16	32	3.5	7.5	25
3529.13	Pg 29	Pg 13	38	4.0	8.0	10
3529.16	Pg 29	Pg 16	38	4.0	8.0	10
3529.21	Pg 29	Pg 21	38	4.0	8.0	10
3536.21	Pg 36	Pg 21	50	4.5	8.5	10
3536.29	Pg 36	Pg 29	50	4.5	8.5	10
3542.29	Pg 42	Pg 29	60	4.0	11.0	10
3542.36	Pg 42	Pg 36	60	4.0	11.0	10
3548.48.36	Pg 48	Pg 36	64	4.0	11.0	10

Reduktionsflansche Messing

mit 6-kant

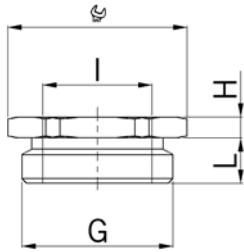

Material: Messing vernickelt
 O-Ring : NBR
 Einsatztemperatur: -40°C / +100°C
 Schutzart: IP 68

Reduction fittings nickel-plated brass

hexagonal

Material: Nickel-plated brass
 O-ring : NBR
 Temperature range: -40°C / +100°C
 Protection class: IP 68



**Aussengewinde Pg
 Innengewinde Gasrohr
 mit O-Ring**

Art.-Nr.	G	I	$\frac{G}{mm}$	H mm	L mm	
35133/8G	Pg 13	G3/8"	24	3	7	50

**Aussengewinde Gasrohr
 Innengewinde Pg
 mit O-Ring**

Art.-Nr.	G	I	$\frac{G}{mm}$	H mm	L mm	
353/8G.07	G3/8"	Pg 7	20	3	10	50
351/2G.09	G1/2"	Pg 9	24	3	9.5	50
353/4G.09	G3/4"	Pg 9	30	3.5	11	50
353/4G.11	G3/4"	Pg 11	30	3.5	11	50
353/4G.16	G3/4"	Pg 16	32	3.5	11	50
351G.21	G 1"	Pg 21	38	3.5	11	25
3511/4G.29	G 1 1/4"	Pg 29	50	5	11	25
352G.36	G 2"	Pg 36	64	5	11	10
352G.42	G 2"	Pg 42	64	5	11	10

Reduktionsflansche Messing

mit 6-kant

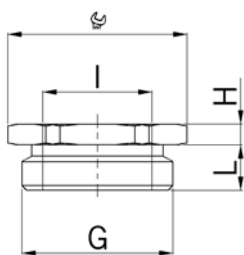

Material: Messing vernickelt
 Einsatztemperatur: -40°C / +100°C
 Schutzart: IP 68 wenn Anschluss-
 gewinde abgedichtet

Reduction fittings nickel-plated brass

hexagonal

Material: Nickel-plated brass
 Temperature range: -40°C / +100°C
 Protection class: IP 68 if the entry thread is
 sealed



**Aussengewinde NPT
 Innengewinde Pg
 ohne O-Ring**

Art.-Nr.	G	I	$\frac{G}{mm}$	H mm	L mm	
351/2NPT.09	NPT1/2"	Pg 9	22	4.5	20	50
353/4NPT.11	NPT3/4"	Pg 11	30	4	20	10
353/4NPT.13	NPT3/4"	Pg 13	30	4	20	10
351NPT.16	NPT 1"	Pg 16	36	6	26	10

Reduktionen Messing

Runde Bauform, randriert

Reduction fittings nickel-plated brass

Round design, knurled

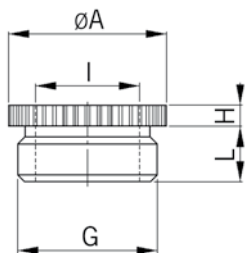

Material: Messing vernickelt
 Einsatztemperatur: -40°C / +200°C
 Schutzart: IP 54
 IP 68 wenn Anschluss-
 gewinde abgedichtet

Material: Nickel-plated brass
 Temperature range: -40°C / +200°C
 Protection class: IP 54
 IP 68 if the entry thread is
 sealed



Aussengewinde metrisch
Innengewinde metrisch
 ohne O-Ring

Outer thread metric
Inner thread metric
 without O-Ring

Art.-Nr.	G	I	ØA mm	H mm	L mm	
3545.17.12	M16x1.5	M12x1.5	18	3	7	100
3545.20.12	M20x1.5	M12x1.5	22	3	8	100
3545.20.17	M20x1.5	M16x1.5	22	3	8	100
3545.25.17	M25x1.5	M16x1.5	27	3	8	50
3545.25.20	M25x1.5	M20x1.5	27	3	8	50
3545.32.20	M32x1.5	M20x1.5	34	4	9	50
3545.32.25	M32x1.5	M25x1.5	34	4	9	50
3545.40.25	M40x1.5	M25x1.5	42	4.5	9	50
3545.40.32	M40x1.5	M32x1.5	42	4.5	9	25
3545.50.32	M50x1.5	M32x1.5	52	4.5	10	25
3545.50.40	M50x1.5	M40x1.5	52	4.5	10	10
3545.63.40	M63x1.5	M40x1.5	65	5	11	10
3545.63.50	M63x1.5	M50x1.5	65	5	11	10

Aussengewinde Pg
Innengewinde metrisch
 ohne O-Ring

Outer thread Pg
Inner thread metric
 without O-Ring

Art.-Nr.	G	I	ØA mm	H mm	L mm	
3545.11.17	Pg 11	M16x1.5	20	10	6	50
3545.16.20	Pg 16	M20x1.5	24	11	6	50
3545.21.20	Pg 21	M20x1.5	30	3.5	7.5	50
3545.21.25	Pg 21	M25x1.5	30	11	7.5	50
3545.29.25	Pg 29	M25x1.5	39	4	8	25
3545.29.32	Pg 29	M32x1.5	39	4	8	25
3545.36.40	Pg 36	M40x1.5	50	4.5	8	10

mit 6-kant

hexagonal

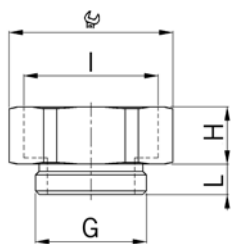

Material: Messing vernickelt
 O-Ring : NBR
 Einsatztemperatur: -40°C / +100°C
 Schutzart: IP 68

Material: Nickel-plated brass
 O-ring : NBR
 Temperature range: -40°C / +100°C
 Protection class: IP 68



**Aussengewinde metrisch
 Innengewinde metrisch**
 mit O-Ring

**Outer thread metric
 Inner thread metric**
 with O-ring

Art.-Nr.	G	I	$\frac{H}{mm}$	H mm	L mm	
3600.06.08	M 6x1.0 ¹⁾	M 8x1.25 ¹⁾	11	8.5	5	50
3600.06.10	M 6x1.0 ¹⁾	M10x1.5 ¹⁾	13	8.5	5	50
3600.08.10	M 8x1.25 ¹⁾	M10x1.5 ¹⁾	13	9	5	50
3600.08.12	M 8x1.25 ¹⁾	M12x1.5	15	9	5	50
3600.10.12	M10x1.5 ¹⁾	M12x1.5	15	9	5	50
3600.10.17	M10x1.5 ¹⁾	M16x1.5	18	9	5	50
3600.12.17	M12x1.5	M16x1.5	18	9	5	50
3600.12.20	M12x1.5	M20x1.5	24	10	5	50
3600.17.20	M16x1.5	M20x1.5	24	10	5	50
3600.20.25	M20x1.5	M25x1.5	30	11.5	6	25
3600.25.32	M25x1.5	M32x1.5	36	14	7	25
3600.32.40	M32x1.5	M40x1.5	46	14	8	25
3600.40.50	M40x1.5	M50x1.5	55	16	8	10
3600.50.63	M50x1.5	M63x1.5	70	17	9	10
3600.63.75	M63x1.5	M75x1.5	80	18	10	10

1) Metrisches Regelgewinde

1) Metric coarse-pitch thread

**Aussengewinde metrisch
 Innengewinde metrisch**
 mit O-Ring

**Outer thread metric
 Inner thread metric**
 with O-ring

Art.-Nr.	G	I	$\frac{H}{mm}$	H mm	L mm	
3600.10.07	M10x1.5 ¹⁾	Pg 7	16	12	6	50
3600.10.09	M10x1.5 ¹⁾	Pg 9	18	12	6	50
3600.12.09	M12x1.5	Pg 9	18	12	7	50
3600.17.11	M16x1.5	Pg 11	22	14	7	50
3600.20.13	M20x1.5	Pg 13	24	15	7	50
3600.20.16	M20x1.5	Pg 16	24	15	7	50
3600.25.21	M25x1.5	Pg 21	32	16	8	25
3600.32.29	M32x1.5	Pg 29	40	16	8	25
3600.40.36	M40x1.5	Pg 36	50	18	8	20
3600.50.42	M50x1.5	Pg 42	60	19	10	10
3600.50.48	M50x1.5	Pg 48	64	20	10	10

1) Metrisches Regelgewinde

1) Metric coarse-pitch thread

mit 6-kant

hexagonal

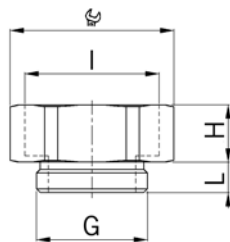

Material: Messing vernickelt
 O-Ring : NBR
 Einsatztemperatur: -40°C / +100°C
 Schutzart: IP 68

Material: Nickel-plated brass
 O-ring : NBR
 Temperature range: -40°C / +100°C
 Protection class: IP 68



Aussengewinde metrisch
Innengewinde metrisch
 mit O-Ring

Outer thread metric
Inner thread metric
 with O-ring

Art.-Nr.	G	I	mm	H mm	L mm	
3600.07.12	Pg 7	M12x1.5	15	9.0	6	50
3600.07.17	Pg 7	M16x1.5	18	9.0	6	50
3600.09.17	Pg 9	M16x1.5	18	9.5	6	50
3600.09.20	Pg 9	M20x1.5	24	10.5	6	50
3600.11.20	Pg 11	M20x1.5	24	10.5	6	50
3600.11.25	Pg 11	M25x1.5	30	11.5	6	25
3600.13.20	Pg 13	M20x1.5	24	10.5	6	50
3600.13.25	Pg 13	M25x1.5	30	11.5	6	25
3600.16.25	Pg 16	M25x1.5	30	11.5	6	25
3600.16.32	Pg 16	M32x1.5	36	13.5	6	25
3600.21.32	Pg 21	M32x1.5	36	14.0	7.5	25
3600.21.40	Pg 21	M40x1.5	46	14.0	7.5	20
3600.29.40	Pg 29	M40x1.5	46	14.0	8	20
3600.29.50	Pg 29	M50x1.5	55	16.0	8	10
3600.36.50	Pg 36	M50x1.5	55	16.0	8	10
3600.36.63	Pg 36	M63x1.5	70	17.0	8	10
3600.42.63	Pg 42	M63x1.5	70	17.0	10	10
3600.42.75	Pg 42	M75x1.5	80	18.0	10	10
3600.48.63	Pg 48	M63x1.5	70	17.0	11	10
3600.48.75	Pg 48	M75x1.5	80	18.0	11	10

Aussengewinde Pg
Innengewinde Pg
 mit O-Ring

Outer thread Pg
Inner thread Pg
 with O-ring

Art.-Nr.	G	I	mm	H mm	L mm	
3607.09.08	Pg 7	Pg 9	18	13	8	50
3609.11.08	Pg 9	Pg 11	22	15	8	50
3609.13.08	Pg 9	Pg 13	24	15	8	50
3611.13.08	Pg 11	Pg 13	24	15	8	50
3611.16.08	Pg 11	Pg 16	24	15	8	50
3611.21.08	Pg 11	Pg 21	32	16	8	50
3613.16.08	Pg 13	Pg 16	24	15	8	50
3616.21.08	Pg 16	Pg 21	32	16	8	25
3616.29.08	Pg 16	Pg 29	40	16	8	25
3621.29.08	Pg 21	Pg 29	40	16	8	25
3629.36.08	Pg 29	Pg 36	50	18	10	20
3636.42.08	Pg 36	Pg 42	60	19	12	10
3636.48.48.08	Pg 36	Pg 48	64	20	12	10

mit 6-kant

hexagonal

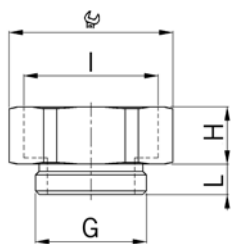

Material: Messing vernickelt
 O-Ring : NBR
 Einsatztemperatur: -40°C / +100°C
 Schutzart: IP 68

Material: Nickel-plated brass
 O-ring : NBR
 Temperature range: -40°C / +100°C
 Protection class: IP 68



**Aussengewinde Pg
 Innengewinde Gasrohr
 mit O-Ring**

**Outer thread Pg
 Inner thread gas-pipe
 with O-ring**

Art.-Nr.	G	I	mm	H mm	L mm	
3636.48.08	Pg 36	G 2"	64	20	12	10
3642.48.08	Pg 42	G 2"	64	20	15	10

**Aussengewinde Pg
 Innengewinde Gasrohr
 mit O-Ring**

**Outer thread Pg
 Inner thread gas-pipe
 with O-ring**

Art.-Nr.	G	I	mm	H mm	L mm	
36161/2G.08	Pg 16	G1/2"	24	14	10	50
36213/4G.08	Pg 21	G3/4"	32	14	12	25

**Aussengewinde Gasrohr
 Gewinde innen Pg
 mit O-Ring**

**Outer thread gas-pipe
 Inner thread Pg
 with O-ring**

Art.-Nr.	G	I	mm	H mm	L mm	
363/8G.11.08	G3/8"	Pg 11	20	12	10	50
361/2G.11.08	G1/2"	Pg 11	24	12	10	50
361/2G.13.08	G1/2"	Pg 13	24	12	10	50
361/2G.16.08	G1/2"	Pg 16	24	12	10	50
365/8G.16.08	G5/8"	Pg 16	24	12	10	50
363/4G.21.08	G3/4"	Pg 21	32	15	12	25
367/8G.29.08	G7/8"	Pg 29	41	15	12	25
361G.29.08	G 1"	Pg 29	41	15	11	25
3611/4G.29.08	G 1 1/4"	Pg 29	45	15	12	10
3611/2G.36.08	G 1 1/2"	Pg 36	54	22	12	10

**Aussengewinde NPT
 Innengewinde Pg**

**Outer thread NPT
 Inner thread Pg**

Art.-Nr.	G	I	mm	H mm	L mm	
361/2NPT.11	NPT1/2"	Pg 11	24	12	20	50
361/2NPT.13	NPT1/2"	Pg 13	24	14	20	50
361/2NPT.16	NPT1/2"	Pg 16	34	20	20	50
363/4NPT.21	NPT3/4"	Pg 21	32	14	20	25

Runde Bauform

Round design

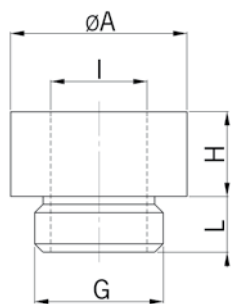

Material: Messing vernickelt
 Einsatztemperatur: -40°C / +200°C
 Schutzart: IP 54
 IP 68 wenn Anschlussgewinde abgedichtet

Material: Nickel-plated brass
 Temperature range: -40°C / +200°C
 Protection class: IP 54
 IP 68 if the entry thread is sealed

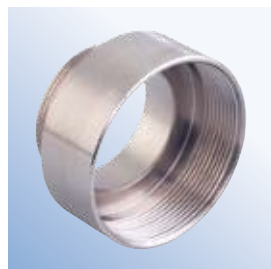

Aussengewinde metrisch Innengewinde metrisch ohne O-Ring

Outer thread metric Inner thread metric without O-Ring

Art.-Nr.	G	I	øA mm	H mm	L mm	
3645.12.17	M12x1.5	M16x1.5	19	9.5	6.5	100
3645.17.20	M16x1.5	M20x1.5	22	10.5	7	100
3645.20.25	M20x1.5	M25x1.5	27	11	8	100
3645.25.32	M25x1.5	M32x1.5	34	12	8	50
3645.32.40	M32x1.5	M40x1.5	42	12	9	50
3645.40.50	M40x1.5	M50x1.5	53	14	9	25
3645.50.63	M50x1.5	M63x1.5	66	19	10	25

Aussengewinde Pg Innengewinde metrisch ohne O-Ring

Outer thread Pg Inner thread metric without O-Ring

Art.-Nr.	G	I	øA mm	H mm	L mm	
3645.07.12	Pg 7	M12x1.5	14	9	6	100
3645.09.17	Pg 9	M16x1.5	19	9.5	6	50
3645.11.20	Pg 11	M20x1.5	22	11	6	50
3645.13.20	Pg 13	M20x1.5	22	11	6	50
3645.16.25	Pg 16	M25x1.5	27	11	6	50
3645.21.32	Pg 21	M32x1.5	34	12	7.5	50
3645.29.40	Pg 29	M40x1.5	42	12	8	10

Verschlusschrauben Messing

Locking plug nickel-plated brass

Kurzes Anschlussgewinde metrisch

Short entry thread metric

Material: Messing vernickelt
 O-Ring : NBR
 Einsatztemperatur: -40°C / +100°C
 Schutzart: IP 68

Material: Nickel-plated brass
 O-ring : NBR
 Temperature range: -40°C / +100°C
 Protection class: IP 68

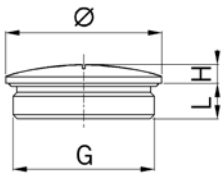

Runde Bauform

Round design

mit O-Ring

with O-ring

Art.-Nr.	G	Ø mm	H mm	L mm	
8706.08	M 6x1.0 ¹⁾	9	3	5	50
8708.08	M 8x1.25 ¹⁾	10	3	5	50
8710.08	M10x1.5 ¹⁾	12	3	5	50
8712.08	M12x1.5	14	3	5	50
8717.08	M16x1.5	19	3	5	50
8720.08	M20x1.5	24	3	6	25
8725.08	M25x1.5	28	4	7	25
8732.08	M32x1.5	35	4	8	10
8740.08	M40x1.5	45	6	8	10
8750.08	M50x1.5	55	6	9	10
8763.08	M63x1.5	70	6	10	10
8775.08	M75x1.5	80	6	11	5

1) Metrisches Regelgewinde

1) Metric coarse-pitch thread

Langes Anschlussgewinde metrisch

Long entry thread metric



Runde Bauform

Round design

mit O-Ring

with O-ring



Art.-Nr.	G	Ø mm	H mm	L mm	
8706.11.08	M 6x1.0 ¹⁾	9	3	8	50
8708.11.08	M 8x1.25 ¹⁾	10	3	10	50
8710.11.08	M10x1.5 ¹⁾	12	3	10	50
8712.11.08	M12x1.5	14	3	10	50
8717.11.08	M16x1.5	19	3	10	50
8720.11.08	M20x1.5	24	3	10	25
8725.11.08	M25x1.5	28	4	11	25
8732.11.08	M32x1.5	35	4	13	10
8740.11.08	M40x1.5	45	6	13	10
8750.11.08	M50x1.5	55	6	14	10
8763.11.08	M63x1.5	70	6	15	10
8775.11.08	M75x1.5	80	6	15	5

1) Metrisches Regelgewinde

1) Metric coarse-pitch thread

Verschlusschrauben Messing

Kurzes Anschlussgewinde Pg

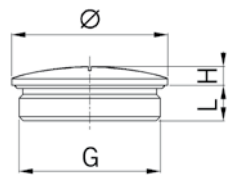

Material: Messing vernickelt
 O-Ring : NBR
 Einsatztemperatur: -40°C / +100°C
 Schutzart: IP 68



Runde Bauform

mit O-Ring

Art.-Nr.	G	Ø mm	H mm	L mm	
8707.08	Pg 7	14	3	5	100
8709.08	Pg 9	17	3	6	100
8711.08	Pg 11	20	3	6	100
8713.08	Pg 13	22	3	6.5	50
8716.08	Pg 16	24	3	6.5	50
8721.08	Pg 21	30	4	7	10
8729.08	Pg 29	39	4	8	10
8736.08	Pg 36	50	6	9	10
8742.08	Pg 42	60	6	10	10
8748.48.08	Pg 48	65	6	10	10

Locking plug nickel-plated brass

Short entry thread Pg

Material: Nickel-plated brass
 O-ring : NBR
 Temperature range: -40°C / +100°C
 Protection class: IP 68

Round design

with O-ring

Langes Anschlussgewinde Pg



Langes Anschlussgewinde Pg

mit O-Ring

Art.-Nr.	G	Ø mm	H mm	L mm	
8707.11.08	Pg 7	14	3	10	100
8709.11.08	Pg 9	17	3	10	100
8711.11.08	Pg 11	20	3	10	100
8713.11.08	Pg 13	22	3	10	50
8716.11.08	Pg 16	24	3	10	50
8721.11.08	Pg 21	30	4	12	10
8729.11.08	Pg 29	39	4	12	10
8736.11.08	Pg 36	50	6	15	10

Long entry thread Pg

Round design

with O-ring

Verschlusschrauben Messing

Kurzes Anschlussgewinde metrisch

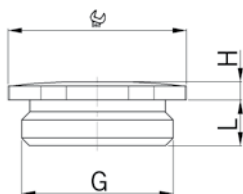

Material: Messing vernickelt
 Einsatztemperatur: -40°C / +200°C
 Schutzart: IP 54
 IP 68 wenn Anschluss-
 gewinde abgedichtet



6-kant

ohne O-Ring

Art.-Nr.	G	Ø mm	H mm	L mm	
8745.12	M12x1.5	14	2.5	5	100
8745.17	M16x1.5	18	2.5	5	100
8745.20	M20x1.5	22	2.5	6	100
8745.25	M25x1.5	27	3.0	7	50
8745.32	M32x1.5	34	3.5	8	25
8745.40	M40x1.5	42	4.0	8	25
8745.50	M50x1.5	52	4.0	9	10
8745.63	M63x1.5	65	4.0	10	10

Locking plug nickel-plated brass

Short entry thread metric

Material: Nickel-plated brass
 Temperature range: -40°C / +200°C
 Protection class: IP 54
 IP 68 if the entry thread is
 sealed

Hexagonal design

without O-Ring

Erdungslaschen Messing zu Kabelverschraubungen

Grounding strap suitable for cable glands

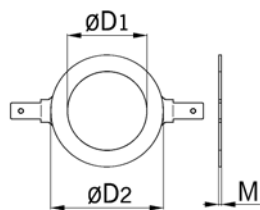

Material: Messing roh
 Einsatztemperatur: -40°C / +200°C
 Einsatzbereich: Löt- oder steckbar
 6,3 x 1,0 mm

Material: Brass
 Temperature range: -40°C / +200°C
 Application: Solderable or pluggable
 6,3 x 1,0 mm

zu Anschlussgewinde metrisch

suitable for metric entry thread



Art.-Nr.	G	ØD1 mm	ØD2 mm	M mm	
1007.80.10	M12 / Pg 7	13.0	24	1	100
1017.80.10	M16	16.5	24	1	100
1020.80.10	M20	20.5	28	1	100
1025.80.10	M25	25.5	32	1	100
1032.80.10	M32	33.0	40	1	100
1040.80.10	M40	40.5	52	1	100
1050.80.10	M50	50.5	62	1	50
1063.80.10	M63	63.5	78	1	50

zu Anschlussgewinde Pg

suitable for entry thread Pg

Art.-Nr.	G	ØD1 mm	ØD2 mm	M mm	
1007.80.10	M12 / Pg 7	13.0	24	1	100
1009.80.10	Pg 9	16.0	24	1	100
1011.80.10	Pg 11	19.0	28	1	100
1013.80.10	Pg 13	21.0	28	1	100
1016.80.10	Pg 16	23.0	32	1	100
1021.80.10	Pg 21	29.0	37	1	100
1029.80.10	Pg 29	38.0	52	1	50
1036.80.10	Pg 36	48.0	62	1	50

Gegenmuttern Stahl rostfrei A2

Steel lock nuts stainless steel A2

Gewinde metrisch

Thread metric

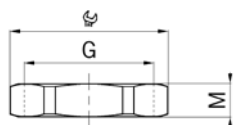

Material: CrNi Stahl A2
 (DIN EN 1.4305 / AISI 303)
 Ausführung: 6-kant
 Einsatztemperatur: -40°C / +300°C

Material: CrNi stainless steel A2
 (DIN EN 1.4305 / AISI 303)
 Execution: Hexagonal design
 Temperature range: -40°C / +300°C

Rostfreier Stahl A2

Stainless steel A2



Art.-Nr.	G	ØG mm	M mm	
8008.96	M 8x1.25 ¹⁾	11	2.8	50
8010.96	M10x1.5 ¹⁾	13	2.8	50
8012.96	M12x1.5	17	3.0	50
8017.96	M16x1.5	19	3.0	50
8020.96	M20x1.5	24	3.5	50
8025.96	M25x1.5	30	3.5	25
8032.96	M32x1.5	36	4.5	25
8040.96	M40x1.5	46	4.5	10
8050.96	M50x1.5	55	5.5	10
8063.96	M63x1.5	70	6.0	5

1) Metrisches Regelgewinde

1) Metric coarse-pitch thread

Gegenmuttern Stahl rostfrei A2

Steel lock nuts stainless steel A2

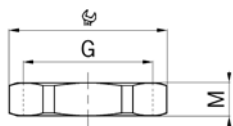

Material: CrNi Stahl A2
(DIN EN 1.4305 / AISI 303)
Ausführung: 6-kant
Einsatztemperatur: -40°C / +300°C

Material: CrNi stainless steel A2
(DIN EN 1.4305 / AISI 303)
Execution: Hexagonal design
Temperature range: -40°C / +300°C

Gewinde Pg

Pg thread



Art.-Nr.	G	$\frac{G}{mm}$	M mm	
8007.96	Pg 7	17	3.5	50
8009.96	Pg 9	19	3.5	50
8011.96	Pg 11	22	3.5	50
8013.96	Pg 13	24	4.0	50
8016.96	Pg 16	27	4.0	50
8021.96	Pg 21	32	4.5	25
8029.96	Pg 29	41	5.5	10
8036.96	Pg 36	51	6.0	10

Gegenmuttern Stahl rostfrei und säurebeständig A4

Steel lock nuts stainless and acid proof steel A4

Material: CrNi Stahl A4
(DIN EN 1.4435 / AISI 316L)
Ausführung: 6-kant
Einsatztemperatur: -40°C / +300°C

Material: CrNi stainless steel A4
(DIN EN 1.4435 / AISI 316L)
Execution: Hexagonal design
Temperature range: -40°C / +300°C

Gewinde metrisch

Metric thread



Art.-Nr.	G	$\frac{G}{mm}$	M mm	
8008.98	M 8x1.25 ¹	11	2.8	50
8010.98	M10x1.5 ¹	13	2.8	50
8012.98	M12x1.5	17	3.0	50
8017.98	M16x1.5	19	3.0	50
8020.98	M20x1.5	24	3.5	50
8025.98	M25x1.5	30	3.5	25
8032.98	M32x1.5	36	4.5	25
8040.98	M40x1.5	46	4.5	10
8050.98	M50x1.5	55	5.5	10
8063.98	M63x1.5	70	6.0	5

1) Metrisches Regelgewinde

1) Metric coarse-pitch thread

Gegenmuttern Stahl verzinkt

Steel lock nuts galvanized steel

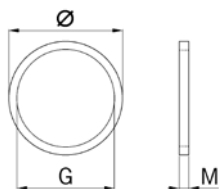

Material: Stahl verzinkt blau
Ausführung: Runde Bauform, randriert
Einsatztemperatur: -40°C / +300°C

Material: Blue zinc coated steel
Execution: Round design, knurled
Temperature range: -40°C / +300°C

Gasrohr-Gewinde

Gas-pipe thread



Art.-Nr.	G	$\frac{\varnothing}{mm}$	M mm	
8050	G 2 1/2"	90	12	60
8051	G 3"	105	12	50

Verschlusschrauben Stahl rostfrei A2

Locking plugs stainless steel A2

Kurzes Anschlussgewinde metrisch

Short thread metric

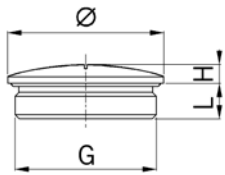

Material: CrNi Stahl A2 (DIN EN 1.4305 / AISI 303)
 O-Ring : NBR
 Einsatztemperatur: -40°C / +100°C
 Schutzart: IP 68

Material: CrNi stainless steel A2 (DIN EN 1.4305 / AISI 303)
 O-ring : NBR
 Temperature range: -40°C / +100°C
 Protection class: IP 68

Runde Bauform

Round design

mit O-Ring

with O-ring



Art.-Nr.	G	Ø mm	H mm	L mm	
8710.96.08.70	M10x1.5 ¹⁾	12	3	5	50
8712.96.08.70	M12x1.5	14	3	5	50
8717.96.08.70	M16x1.5	19	3	5	50
8720.96.08.70	M20x1.5	24	3	6	25
8725.96.08.70	M25x1.5	28	4	7	25
8732.96.08.70	M32x1.5	35	4	8	10
8740.96.08.70	M40x1.5	45	6	8	10
8750.96.08.70	M50x1.5	55	6	9	10
8763.96.08.70	M63x1.5	70	6	10	10
8775.96.08.70	M75x1.5	80	6	11	5

1) Metrisches Regelgewinde

1) Metric coarse-pitch thread

Langes Anschlussgewinde metrisch

Long thread metric



Runde Bauform

Round design

mit O-Ring

with O-ring

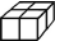
Art.-Nr.	G	Ø mm	H mm	L mm	
8710.96.11.08.70	M10x1.5 ¹⁾	12	3	10	50
8712.96.11.08.70	M12x1.5	14	3	10	50
8717.96.11.08.70	M16x1.5	19	3	10	50
8720.96.11.08.70	M20x1.5	24	3	10	25
8725.96.11.08.70	M25x1.5	28	4	11	25
8732.96.11.08.70	M32x1.5	35	4	13	10
8740.96.11.08.70	M40x1.5	45	6	13	10
8750.96.11.08.70	M50x1.5	55	6	14	10
8763.96.11.08.70	M63x1.5	70	6	15	10
8775.96.11.08.70	M75x1.5	80	6	15	5

1) Metrisches Regelgewinde

1) Metric coarse-pitch thread

Auf Anfrage lieferbar:
Anschlussgewinde Pg

Available on request:
Entry thread Pg

Verschlusschrauben Stahl rostfrei A2 für hohe Temperaturen

Kurzes Anschlussgewinde metrisch

Locking plugs stainless steel A2 for high temperature applications

Short thread metric

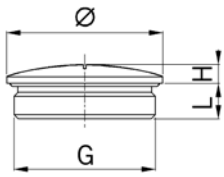

Material: CrNi Stahl A2 (DIN EN 1.4305 / AISI 303)
O-Ring : FPM
Einsatztemperatur: -40°C / +200°C
Schutzart: IP 68

Material: CrNi stainless steel A2 (DIN EN 1.4305 / AISI 303)
O-ring : FPM
Temperature range: -40°C / +200°C
Protection class: IP 68



Runde Bauform

mit O-Ring

Art.-Nr.	G	Ø mm	H mm	L mm	
8710.96.08	M10x1.5 ¹⁾	12	3	5	50
8712.96.08	M12x1.5	14	3	5	50
8717.96.08	M16x1.5	19	3	5	50
8720.96.08	M20x1.5	24	3	6	25
8725.96.08	M25x1.5	28	4	7	25
8732.96.08	M32x1.5	35	4	8	10
8740.96.08	M40x1.5	45	6	8	10
8750.96.08	M50x1.5	55	6	9	10
8763.96.08	M63x1.5	70	6	10	10
8775.96.08	M75x1.5	80	6	11	5

1) Metrisches Regelgewinde

Round design

with O-ring

Art.-Nr.	G	Ø mm	H mm	L mm	
8710.96.08	M10x1.5 ¹⁾	12	3	5	50
8712.96.08	M12x1.5	14	3	5	50
8717.96.08	M16x1.5	19	3	5	50
8720.96.08	M20x1.5	24	3	6	25
8725.96.08	M25x1.5	28	4	7	25
8732.96.08	M32x1.5	35	4	8	10
8740.96.08	M40x1.5	45	6	8	10
8750.96.08	M50x1.5	55	6	9	10
8763.96.08	M63x1.5	70	6	10	10
8775.96.08	M75x1.5	80	6	11	5

1) Metric coarse-pitch thread

Langes Anschlussgewinde metrisch

Long thread metric



Runde Bauform

mit O-Ring

Art.-Nr.	G	Ø mm	H mm	L mm	
8710.96.11.08	M10x1.5 ¹⁾	12	3	10	50
8712.96.11.08	M12x1.5	14	3	10	50
8717.96.11.08	M16x1.5	19	3	10	50
8720.96.11.08	M20x1.5	24	3	10	25
8725.96.11.08	M25x1.5	28	4	11	25
8732.96.11.08	M32x1.5	35	4	13	10
8740.96.11.08	M40x1.5	45	6	13	10
8750.96.11.08	M50x1.5	55	6	14	10
8763.96.11.08	M63x1.5	70	6	15	10
8775.96.11.08	M75x1.5	80	6	15	5

1) Metrisches Regelgewinde

Round design

with O-ring

Art.-Nr.	G	Ø mm	H mm	L mm	
8710.96.11.08	M10x1.5 ¹⁾	12	3	10	50
8712.96.11.08	M12x1.5	14	3	10	50
8717.96.11.08	M16x1.5	19	3	10	50
8720.96.11.08	M20x1.5	24	3	10	25
8725.96.11.08	M25x1.5	28	4	11	25
8732.96.11.08	M32x1.5	35	4	13	10
8740.96.11.08	M40x1.5	45	6	13	10
8750.96.11.08	M50x1.5	55	6	14	10
8763.96.11.08	M63x1.5	70	6	15	10
8775.96.11.08	M75x1.5	80	6	15	5

1) Metric coarse-pitch thread

Auf Anfrage lieferbar:
Anschlussgewinde Pg

Available on request:
Entry thread Pg

Gegenmuttern Kunststoff

Synthetic lock nuts

1 Gewinde metrisch

Thread metric

Material: Polyamid glasfaserverstärkt

Material: Polyamide glass fiber reinforced

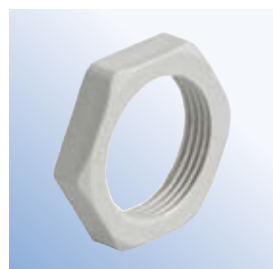
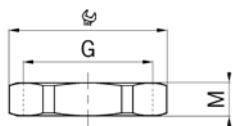

Einsatztemperatur: -40°C / +100°C

Temperature range: -40°C / +100°C



Hellgrau RAL 7035

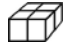

Light grey RAL 7035

Art.-Nr.	G	 mm	M	 mm	
8212	M12x1.5	17	5.5	100	100
8217	M16x1.5	22	5.5	100	100
8220	M20x1.5	26	6.5	100	100
8225	M25x1.5	32	7.0	100	100
8232	M32x1.5	41	7.0	100	100
8240	M40x1.5	50	7.0	50	50
8250	M50x1.5	60	8.5	10	10

Schwarz RAL 9005

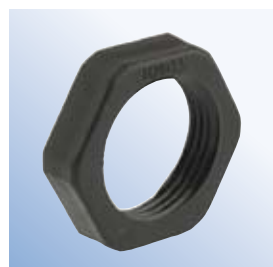
Black RAL 9005

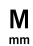

Art.-Nr.	G	 mm	M	 mm	
8212.40	M12x1.5	17	5.5	100	100
8217.40	M16x1.5	22	5.5	100	100
8220.40	M20x1.5	26	6.5	100	100
8225.40	M25x1.5	32	7.0	100	100
8232.40	M32x1.5	41	7.0	100	100
8240.40	M40x1.5	50	7.0	50	50
8250.40	M50x1.5	60	8.5	10	10

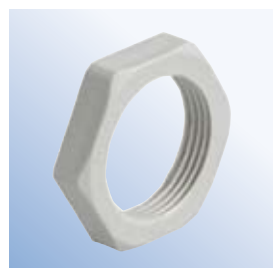

5 Gewinde Pg

Thread Pg



Hellgrau RAL 7035



Light grey RAL 7035

Art.-Nr.	G	 mm	M	 mm	
8207	Pg 7	19	5.0	100	100
8209	Pg 9	22	6.0	100	100
8211	Pg 11	24	6.0	100	100
8213	Pg 13	27	6.0	100	100
8216	Pg 16	30	6.0	100	100
8221	Pg 21	36	7.0	100	100
8229	Pg 29	46	7.0	50	50
8236	Pg 36	60	8.0	25	25
8242	Pg 42	65	8.0	25	25
8248.48	Pg 48	70	8.0	25	25

Gewinde Pg Schwarz RAL 9005

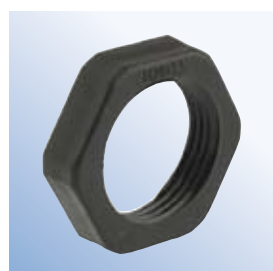
Pg thread Black RAL 9005



Art.-Nr.	G	 mm	M	 mm	
8207.40	Pg 7	19	5.0	100	100
8209.40	Pg 9	22	6.0	100	100
8211.40	Pg 11	24	6.0	100	100
8213.40	Pg 13	27	6.0	100	100
8216.40	Pg 16	30	6.0	100	100
8221.40	Pg 21	36	7.0	100	100
8229.40	Pg 29	46	7.0	50	50
8236.40	Pg 36	60	8.0	25	25
8242.40	Pg 42	65	8.0	25	25
8248.48.40	Pg 48	70	8.0	25	25

Gegenmuttern Kunststoff mit Flansch

Synthetic lock nut with flange

Gewinde metrisch

Thread metric

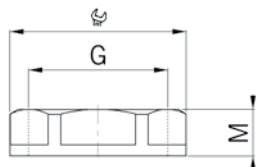

Material: Polyamid PA 6
Einsatztemperatur: -30°C / +100°C

Material: Polyamide PA 6
Temperature range: -30°C / +100°C





Hellgrau RAL 7035

Light grey RAL 7035

Art.-Nr.	G	 mm	M mm	
8255.12	M12x1.5	17	5.0	100
8255.17	M16x1.5	22	5.0	100
8255.20	M20x1.5	27	6.0	100
8255.25	M25x1.5	33	6.7	100
8255.32	M32x1.5	42	7.9	50
8255.40	M40x1.5	48	8.4	50
8255.50	M50x1.5	59	9.9	10
8255.63	M63x1.5	73	11.0	10

Schwarz RAL 9005

Black RAL 9005

Art.-Nr.	G	 mm	M mm	
8245.12	M12x1.5	17	5.0	100
8245.17	M16x1.5	22	5.0	100
8245.20	M20x1.5	27	6.0	100
8245.25	M25x1.5	33	6.7	100
8245.32	M32x1.5	42	7.9	50
8245.40	M40x1.5	48	8.4	50
8245.50	M50x1.5	59	9.9	10
8245.63	M63x1.5	73	11.0	10



Gewinde Pg

Thread Pg





Hellgrau RAL 7035

Light grey RAL 7035

Art.-Nr.	G	 mm	M mm	
8255.07	Pg 7	19	5.0	100
8255.09	Pg 9	22	5.0	100
8255.11	Pg 11	24	5.0	100
8255.13	Pg 13	27	6.0	100
8255.16	Pg 16	30	6.0	100
8255.21	Pg 21	36	7.0	50
8255.29	Pg 29	46	8.0	50
8255.36	Pg 36	60	8.0	25
8255.42	Pg 42	65	8.0	10
8255.48	Pg 48	70	8.0	10

Schwarz RAL 9005

Black RAL 9005

Art.-Nr.	G	 mm	M mm	
8245.07	Pg 7	19	5.0	100
8245.09	Pg 9	22	5.0	100
8245.11	Pg 11	24	5.0	100
8245.13	Pg 13	27	6.0	100
8245.16	Pg 16	30	6.0	100
8245.21	Pg 21	36	7.0	50
8245.29	Pg 29	46	8.0	50
8245.36	Pg 36	60	8.0	25
8245.42	Pg 42	65	8.0	10
8245.48	Pg 48	70	8.0	10



Erweiterungen Kunststoff

Synthetic enlarging fittings

rund mit 6-kant

round with hexagon

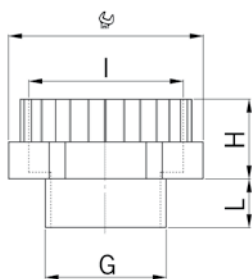

Material: Polyamid PA 6
 Einsatztemperatur: -30°C / +100°C
 Schutzart: IP 54
 IP 68 wenn Anschluss-
 gewinde abgedichtet

Material: Polyamide PA 6
 Temperature range: -30°C / +100°C
 Protection class: IP 54
 IP 68 if the entry thread is
 sealed

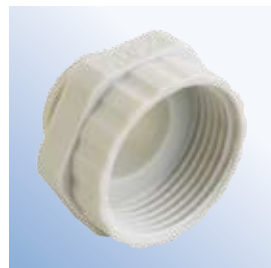

Aussengewinde metrisch
Innengewinde metrisch
 Hellgrau RAL 7035

Outer thread metric
Inner thread metric
 Light grey RAL 7035

Art.-Nr.	G	I	\varnothing mm	H mm	L mm	
3755.12.17	M12x1.5	M16x1.5	20	13	8	100
3755.17.20	M16x1.5	M20x1.5	24	13	8	100
3755.20.25	M20x1.5	M25x1.5	29	13	8	100
3755.25.32	M25x1.5	M32x1.5	36	15	8	50
3755.32.40	M32x1.5	M40x1.5	46	15	10	25
3755.40.50	M40x1.5	M50x1.5	55	15	10	10
3755.50.63	M50x1.5	M63x1.5	68	15	10	10

Aussengewinde Pg
Innengewinde metrisch
 Hellgrau RAL 7035

Outer thread Pg
Inner thread metric
 Light grey RAL 7035

Art.-Nr.	G	I	\varnothing mm	H mm	L mm	
3755.07.12	Pg 7	M12x1.5	15	12	8	100
3755.07.17	Pg 7	M16x1.5	20	12	8	100
3755.09.17	Pg 9	M16x1.5	20	12	8	100
3755.09.20	Pg 9	M20x1.5	24	12	8	100
3755.11.20	Pg 11	M20x1.5	24	12	8	100
3755.13.25	Pg 13	M25x1.5	30	13	9	100
3755.16.25	Pg 16	M25x1.5	30	13	10	50
3755.21.32	Pg 21	M32x1.5	37	14	11	50
3755.29.40	Pg 29	M40x1.5	45	14	11	50
3755.42.50	Pg 42	M50x1.5	55	17	11	10
3755.48.63	Pg 48	M63x1.5	68	17	11	5

Erweiterungen Kunststoff

rund mit 6-kant

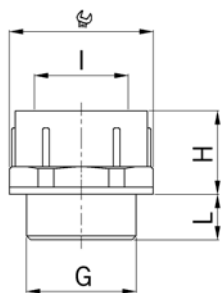

Material: Polyamid glasfaserverstärkt
 Einsatztemperatur: -20°C / +100°C
 Schutzart: IP 54
 IP 68 wenn Anschluss-
 gewinde abgedichtet



Synthetic enlarging fittings

round with hexagon

Material: Polyamide glass fiber reinforced
 Temperature range: -20°C / +100°C
 Protection class: IP 54
 IP 68 if the entry thread is sealed



Aussengewinde Pg Innengewinde Pg Hellgrau

Art.-Nr.	G	I	 mm	H mm	L mm	
3707.09	Pg 7	Pg 9	19	18	7	50
3709.11	Pg 9	Pg 11	22	19	7	50
3711.13	Pg 11	Pg 13	24	21	8	50
3713.16	Pg 13	Pg 16	27	23	9	50
3716.21	Pg 16	Pg 21	32	26	9	25
3721.29	Pg 21	Pg 29	41	33	10	25
3729.36	Pg 29	Pg 36	55	39	12	10
3736.42	Pg 36	Pg 42	60	46	14	10
3742.48	Pg 42	Pg 48	65	39	16	10

Aussengewinde metrisch Innengewinde Pg Hellgrau

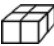
Art.-Nr.	G	I	 mm	H mm	L mm	
3712.09	M12x1.5	Pg 9	19	13	11	50
3720.13	M20x1.5	Pg 13	24	15	11	50
3720.16	M20x1.5	Pg 16	27	17	11	50
3725.21	M25x1.5	Pg 21	33	20	11	25
3732.29	M32x1.5	Pg 29	42	22	11	25
3750.42	M50x1.5	Pg 42	60	28	11	10

Reduktionsflansche Kunststoff

Synthetic reduction fittings

mit 6-kant

hexagonal

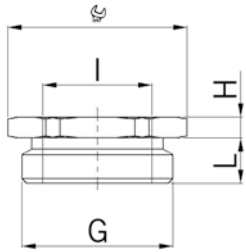

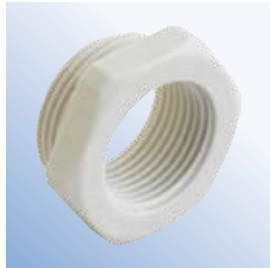

Material: Polyamid PA 6
Einsatztemperatur: -30°C / +100°C
Schutzart: IP 54
IP 68 wenn Anschluss-
gewinde abgedichtet

Material: Polyamide PA 6
Temperature range: -30°C / +100°C
Protection class: IP 54
IP 68 if the entry thread is
sealed



Aussengewinde metrisch
Innengewinde metrisch
Hellgrau RAL 7035

Outer thread metric
Inner thread metric
Light grey RAL 7035

Art.-Nr.	G	I	 mm	H mm	L mm	
3455.17.12	M16x1.5	M12x1.5	22	4	8	100
3455.20.12	M20x1.5	M12x1.5	24	4	8	100
3455.20.17	M20x1.5	M16x1.5	24	4	8	100
3455.25.12	M25x1.5	M12x1.5	29	6	8	100
3455.25.17	M25x1.5	M16x1.5	29	6	8	100
3455.25.20	M25x1.5	M20x1.5	29	6	8	100
3455.32.12	M32x1.5	M12x1.5	36	6	10	50
3455.32.17	M32x1.5	M16x1.5	36	6	10	50
3455.32.20	M32x1.5	M20x1.5	36	6	10	50
3455.32.25	M32x1.5	M25x1.5	36	6	10	50
3455.40.17	M40x1.5	M16x1.5	46	6	10	50
3455.40.20	M40x1.5	M20x1.5	46	6	10	50
3455.40.25	M40x1.5	M25x1.5	46	6	10	25
3455.40.32	M40x1.5	M32x1.5	46	6	10	25
3455.50.20	M50x1.5	M20x1.5	55	6	12	5
3455.50.25	M50x1.5	M25x1.5	55	6	12	5
3455.50.32	M50x1.5	M32x1.5	55	6	12	5
3455.50.40	M50x1.5	M40x1.5	55	6	12	5
3455.63.25	M63x1.5	M25x1.5	68	6	12	5
3455.63.32	M63x1.5	M32x1.5	68	6	12	5
3455.63.40	M63x1.5	M40x1.5	68	6	12	5
3455.63.50	M63x1.5	M50x1.5	68	6	12	5

Reduktionsflansche Kunststoff

Synthetic reduction fittings

mit 6-kant

hexagonal

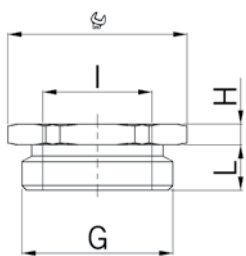

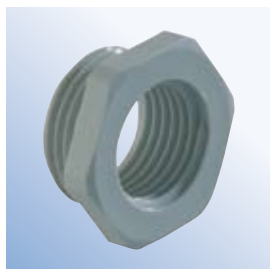

Material: Polyamid glasfaserverstärkt
Einsatztemperatur: -20°C / +100°C
Schutzart: IP 54
IP 68 wenn Anschluss-
gewinde abgedichtet

Material: Polyamide glass fiber
reinforced
Temperature range: -20°C / +100°C
Protection class: IP 54
IP 68 if the entry thread is
sealed



Aussengewinde Pg
Innengewinde Pg
Hellgrau

Outer thread Pg
Inner thread Pg
Light grey

Art.-Nr.	G	I	 mm	H mm	L mm	
3409.07	Pg 9	Pg 7	19	12	8	50
3411.07	Pg 11	Pg 7	22	3	8	50
3411.09	Pg 11	Pg 9	22	15	8	50
3413.09	Pg 13	Pg 9	24	3	9	50
3413.11	Pg 13	Pg 11	24	15	9	50
3416.09	Pg 16	Pg 9	27	5	9	50
3416.11	Pg 16	Pg 11	27	5	9	50
3416.13	Pg 16	Pg 13	27	17	10	50
3421.13	Pg 21	Pg 13	32	5	11	25
3421.16	Pg 21	Pg 16	32	5	11	25
3429.21	Pg 29	Pg 21	41	6	12	10
3436.29	Pg 36	Pg 29	50	6	14	10

Reduktionen Kunststoff

rund mit 6-kant

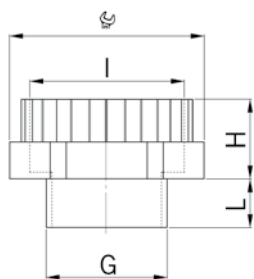

Material: Polyamid PA 6
Einsatztemperatur: -30°C / +100°C
Schutzart: IP 54
IP 68 wenn Anschluss-
gewinde abgedichtet

Synthetic reduction fittings

round with hexagon

Material: Polyamide PA 6
Temperature range: -30°C / +100°C
Protection class: IP 54
IP 68 if the entry thread is
sealed

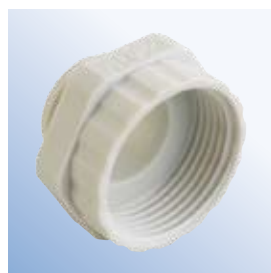

**Aussengewinde Pg
Innengewinde metrisch**
Hellgrau RAL 7035

**Outer thread Pg
Inner thread metric**
Light grey RAL 7035

Art.-Nr.	G	I	G mm	H mm	L mm	
3455.09.12	Pg 9	M12x1.5	19	12	8	100
3455.11.17	Pg 11	M16x1.5	22	12	8	100
3455.13.17	Pg 13	M16x1.5	24	13	9	100
3455.13.20	Pg 13	M20x1.5	24	13	9	100
3455.16.20	Pg 16	M20x1.5	27	13	10	50
3455.21.25	Pg 21	M25x1.5	33	14	11	50
3455.29.32	Pg 29	M32x1.5	42	14	11	50
3455.36.40	Pg 36	M40x1.5	55	14	11	25

Reduktionen Kunststoff

mit 6-kant

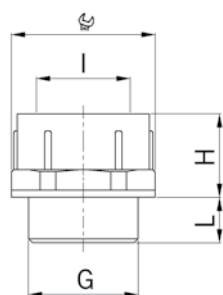

Material: Polyamid glasfaserverstärkt
Einsatztemperatur: -20°C / +100°C
Schutzart: IP 54
IP 68 wenn Anschluss-
gewinde abgedichtet

Synthetic reduction fittings

hexagonal

Material: Polyamide glass fiber
reinforced
Temperature range: -20°C / +100°C
Protection class: IP 54
IP 68 if the entry thread is
sealed



**Aussengewinde metrisch
Gewinde innen Pg**
Hellgrau

**Outer thread metric
Inner thread Pg**
Light grey

Art.-Nr.	G	I	G mm	H mm	L mm	
3417.09	M16x1.5	Pg 9	19	14	11	50
3420.11	M20x1.5	Pg 11	22	16	11	50
3425.16	M25x1.5	Pg 16	27	18	11	50
3440.29	M40x1.5	Pg 29	42	23	11	25
3450.36	M50x1.5	Pg 36	53	26	11	10
3463.48	M63x1.5	Pg 48	65	29	11	5

Verschlusschrauben Kunststoff

Synthetic locking plug

Gewinde metrisch

Thread metric

Material: Polyamid PA 6
 Einsatztemperatur: -30°C / +100°C
 Schutzart: IP 54
 IP 68 wenn Anschluss-
 gewinde abgedichtet

Material: Polyamide PA 6
 Temperature range: -30°C / +100°C
 Protection class: IP 54
 IP 68 if the entry thread is
 sealed

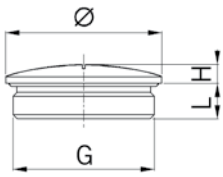

Anschlussgewinde metrisch Hellgrau RAL 7035 ohne O-Ring

Entry thread metric Light grey RAL 7035 without O-Ring

Art.-Nr.	G	Ø mm	H mm	L mm	
8855.12	M12x1.5	15	4.5	6	100
8855.17	M16x1.5	20	4.5	6	100
8855.20	M20x1.5	24	4.5	6	100
8855.25	M25x1.5	30	5.0	8	100
8855.32	M32x1.5	37	5.5	8	50
8855.40	M40x1.5	46	6.0	8	50
8855.50	M50x1.5	56	6.0	10	10
8855.63	M63x1.5	70	6.0	12	10

Anschlussgewinde metrisch Schwarz RAL 9005 ohne O-Ring

Entry thread metric Black RAL 9005 without O-Ring

Art.-Nr.	G	Ø mm	H mm	L mm	
8845.12	M12x1.5	15	4.5	6	100
8845.17	M16x1.5	20	4.5	6	100
8845.20	M20x1.5	24	4.5	6	100
8845.25	M25x1.5	30	5.0	8	100
8845.32	M32x1.5	37	5.5	8	50
8845.40	M40x1.5	46	6.0	8	50
8845.50	M50x1.5	56	6.0	10	10
8845.63	M63x1.5	70	6.0	12	10



Verschlusschrauben Kunststoff

Synthetic locking plug

Gewinde Pg

Thread Pg

Material: Polystyrol schlagfest
 Einsatztemperatur: -20°C / +80°C
 Schutzart: IP 54
 IP 68 wenn Anschluss-
 gewinde abgedichtet

Material: Polystyrene shock-resistant
 Temperature range: -20°C / +80°C
 Protection class: IP 54
 IP 68 if the entry thread is
 sealed

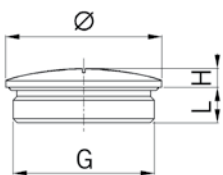

Gewinde Pg Hellgrau RAL 7035 ohne O-Ring

Pg thread Light grey RAL 7035 without O-Ring

Art.-Nr.	G	Ø mm	H mm	L mm	
8807	Pg 7	15	2.0	6.0	100
8809	Pg 9	19	3.0	6.5	100
8811	Pg 11	22	3.5	6.5	100
8813	Pg 13	25	3.5	6.5	100
8816	Pg 16	27	3.5	6.5	100
8821	Pg 21	33	4.0	8.0	100
8829	Pg 29	44	4.0	8.0	50
8836	Pg 36	55	4.0	10.0	25
8842	Pg 42	62	4.0	10.0	10
8848.48	Pg 48	69	4.0	12.0	25

Dichtungseinsätze Vollgummi

passend zu Kabelverschraubungen Progress®

Material: NBR
Einsatztemperatur: -40°C / +100°C

Solig rubber sealing inserts

suitable for cable glands Progress®

Material: NBR
Temperature range: -40°C / +100°C

Kurzer Dichtungseinsatz ohne Bohrung

Short sealing insert without drilled hole

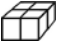

Art.-Nr.	G	>Ø< mm	
1000.06.30.03	M 6	3.5	1
1000.08.30.03	M 8	5.0	1
1000.10.30.03	M10	6.0	1
1000.11.30.03	Pg 11	12.0	1
1000.12.30.03	M12 / Pg 7	8.0	1
1000.17.30.03	M16 / Pg 9	10.5	1
1000.20.30.03	M20 / Pg 13+16	15.0	1
1000.25.30.03	M25 / Pg 21	20.5	1
1000.29.30.03	Pg 29	27.5	1
1000.32.30.03	M32	25.5	1
1000.36.30.03	Pg 36	35.0	1
1000.40.30.03	M40	33.0	1
1000.48.30.03	Pg 48	49.0	1
1000.50.30.03	M50 / Pg 42	42.0	1
1000.63.30.03	M63	52.0	1
1000.75.30.03	M75	63.0	1
1000.085.30.03	M85	70.0	1
1000.095.30.03	M95	80.0	1
1000.100.30.03	M100	85.0	1
1000.105.30.03	M105	90.0	1
1000.115.30.03	M115	95.0	1

Dichtungseinsätze Vollgummi für hohe Temperaturen

passend zu Kabelverschraubungen Progress®

Material: FPM
Einsatztemperatur: -40°C / +200°C

Solid rubber sealing inserts for high temperatures applications

suitable for cable glands Progress®

Material: FPM
Temperature range: -40°C / +200°C

Kurzer Dichtungseinsatz ohne Bohrung

Short sealing insert without drilled hole



Art.-Nr.	G	>Ø< mm	
1000.06.98.30.03	M 6	3.5	1
1000.08.98.30.03	M 8	5.0	1
1000.10.98.30.03	M10	6.0	1
1000.11.98.30.03	Pg 11	12.0	1
1000.12.98.30.03	M12 / Pg 7	8.0	1
1000.17.98.30.03	M16 / Pg 9	10.5	1
1000.20.98.30.03	M20 / Pg 16	15.0	1
1000.25.98.30.03	M25 / Pg 21	20.5	1
1000.29.98.30.03	Pg 29	27.5	1
1000.32.98.30.03	M32	25.5	1
1000.36.98.30.03	Pg 36	35.0	1
1000.40.98.30.03	M40 / Pg 29	33.0	1
1000.48.98.30.03	Pg 48	49.0	1
1000.50.98.30.03	M50 / Pg 42	42.0	1
1000.63.98.30.03	M63	52.0	1

O-Ringe

passend zu Kabelverschraubungen Progress®

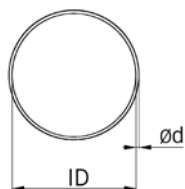

Material: NBR
Einsatztemperatur: -40°C / +100°C

O-rings

suitable for cable glands Progress®

Material: NBR
Temperature range: -40°C / +100°C

zu Anschlussgewinde metrisch oder Pg

suitable for entry thread metric or Pg

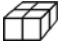

Art.-Nr.	G	ID mm	ød mm	
1005.00.08	M 6	5.0	1.0	1
1006.00.08	M 8	6.0	1.5	1
1006.06.08	M10	8.1	1.6	1
1007.00.08	M12 / Pg 7	10.0	1.5	1
1000.09.00.08	M 16 / Pg 9	13.1	1.6	1
2111.00.08	M20	17.0	2.0	1
1013.00.22.08	M25	22.0	2.0	1
1021.00.30.08	M32	30.0	2.0	1
1000.40.00.08	M40	36.0	2.0	1
1000.50.00.08	M50	46.0	2.0	1
1000.63.00.08	M63	60.0	2.0	1
1000.75.00.08	M75	72.0	2.0	1
1011.00.08	Pg 11	15.0	2.0	1
1016.00.08	Pg 13 / Pg 16	19.0	2.0	1
1016.00.25.08	Pg 21	25.0	2.0	1
1029.00.08	Pg 29	33.0	1.8	1
1036.00.08	Pg 36	42.5	2.6	1
1000.42.00.08	Pg 42	48.0	3.0	1
1000.48.00.08	Pg 48	55.0	2.0	1

O-Ringe für hohe Temperaturen

passend zu Kabelverschraubungen Progress®

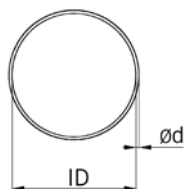

Material: FPM
Einsatztemperatur: -40°C / +200°C

O-rings for high temperatures

suitable for cable glands Progress®

Material: FPM
Temperature range: -40°C / +200°C

zu Anschlussgewinde metrisch oder Pg

suitable for entry thread metric or Pg

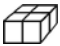

Art.-Nr.	G	ID mm	ød mm	
1105.98.08	M 6	5.0	1.0	1
1106.98.08	M 8	6.0	1.5	1
1106.06.98.08	M10	8.1	1.6	1
1107.98.08	M12 / Pg 7	10.0	1.5	1
1100.09.98.08	M16 / Pg 9	13.1	1.6	1
2111.98.08	M20	17.0	2.0	1
1113.98.22.08	M25	22.0	2.0	1
1121.98.30.08	M32	30.0	2.0	1
1100.40.98.08	M40	36.0	2.0	1
1100.50.98.08	M50	46.0	2.0	1
1100.63.98.08	M63	60.0	2.0	1
1100.75.98.08	M75	72.0	2.0	1
1111.98.08	Pg 11	15.0	2.0	1
1116.98.08	Pg 13 / Pg 16	18.0	2.0	1
1116.98.25.08	Pg 21	25.0	2.0	1
1129.98.08	Pg 29	33.0	1.8	1
1136.98.08	Pg 36	42.5	2.6	1
1100.42.98.08	Pg 42	48.0	3.0	1
1100.48.98.08	Pg 48	55.0	2.0	1

Dichtungsscheiben

passend zu Kabelverschraubungen Progress®

Sealing washer

suitable for cable glands Progress®

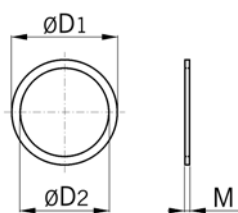

Material: KlingerSIL C-4300
Einsatztemperatur: -30°C / +300°C
Farbe: Grün

Material: KlingerSIL C-4300
Temperature range: -30°C / +300°C
Colour: Green

zu Anschlussgewinde metrisch

suitable for metric entry thread



Art.-Nr.	G	ØD1 mm	ØD2 mm	M mm	
1006.00.16	M 6	10.0	6.0	1.5	1
1008.00.16	M 8	12.0	8.0	1.5	1
1010.00.16	M10	14.0	10.0	1.5	1
1012.00.16	M12	16.0	12.0	1.5	1
1017.00.16	M16	21.0	16.0	1.5	1
1013.00.16	M20 / Pg 13	25.0	20.5	1.5	1
1025.00.16	M25	31.0	25.0	2.0	1
1032.00.16	M32	39.0	32.0	2.0	1
1040.00.16	M40	48.0	40.0	2.0	1
1050.00.16	M50	59.0	50.0	2.0	1
1063.00.16	M63	73.0	63.0	2.0	1

zu Anschlussgewinde Pg

suitable for entry thread Pg

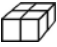
Art.-Nr.	G	ØD1 mm	ØD2 mm	M mm	
1007.00.16	Pg 7	16.5	12.5	1.5	1
1009.00.16	Pg 9	19.0	15.2	1.5	1
1011.00.16	Pg 11	22.5	18.5	1.5	1
1013.00.16	M20 / Pg 13	25.0	20.5	1.5	1
1016.00.16	Pg 16	27.0	22.5	1.5	1
1021.00.16	Pg 21	33.5	28.5	2.0	1
1029.00.16	Pg 29	43.5	37.0	2.0	1
1036.00.16	Pg 36	55.0	47.0	2.0	1
1042.00.16	Pg 42	63.0	54.0	2.0	1
1048.00.16	Pg 48	69.0	59.3	2.0	1

Dichtungsscheiben

passend zu Kabelverschraubungen Syntec®

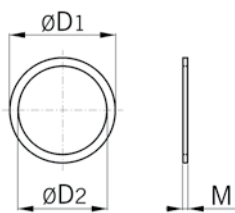

Material: Perbunan
Einsatztemperatur: -20°C / +100°C

Sealing washer

suitable for cable glands Syntec®

Material: Perbunan
Temperature range: -20°C / +100°C

zu Anschlussgewinde metrisch

suitable for metric entry thread



Art.-Nr.	G	$\varnothing D1$ mm	$\varnothing D2$ mm	M mm	
1012.45.16	M12	20	12	1.6	50
1017.45.16	M16	23	16	1.8	50
1020.45.16	M20	29	20	1.8	50
1025.45.16	M25	37	25	1.8	50
1032.45.16	M32	44	32	2.2	25
1040.45.16	M40	52	40	2.2	25
1050.45.16	M50	64	50	2.7	25
1063.45.16	M63	68	63	3.2	10

zu Anschlussgewinde Pg

suitable for entry thread Pg

Art.-Nr.	G	$\varnothing D1$ mm	$\varnothing D2$ mm	M mm	
1007.45.16	Pg 7	16.0	11.5	2.0	50
1009.45.16	Pg 9	19.0	14.0	2.0	50
1011.45.16	Pg 11	22.5	18.5	2.0	50
1013.45.16	Pg 13	25.0	19.0	2.0	50
1016.45.16	Pg 16	27.0	21.0	2.0	50
1021.45.16	Pg 21	34.0	27.0	2.5	25
1029.45.16	Pg 29	43.0	35.0	2.5	25
1036.45.16	Pg 36	54.0	45.0	2.5	25

Blindscheiben passend zu Kabelverschraubungen

Blind discs suitable for cable glands

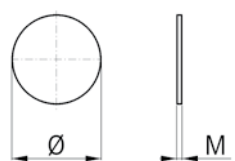

Material: Polyamid
Einsatztemperatur: -20°C / +100°C
Einsatzbereich: Staubverschluss zu Kabelverschraubungen

Material: Polyamide
Temperature range: -20°C / +100°C
Application: Dust stopper for cable glands

Blindscheibe als Staubschutz

Blind disc for dust protection



Art.-Nr.	G	\varnothing mm	M mm	
1012.00.19	M10 / M12 / Pg 7	10.5	0.3	50
1017.00.19	M16 / Pg 9	13.5	0.3	50
1011.00.19	Pg 11	16.5	0.3	50
1020.00.19	M20 / Pg 13 / Pg 16	20.5	0.3	50
1025.00.19	M25 / Pg 21	26.5	0.3	50
1029.00.19	Pg 29	35.0	0.3	50
1032.00.19	M32	30.0	0.3	50
1036.00.19	Pg 36	45.0	0.3	50
1040.00.19	M40	38.0	0.3	50
1050.00.19	M50 / Pg 42	52.0	0.3	50
1063.00.19	M63 / Pg 48	57.0	0.3	50

Verschlussbolzen aus Kunststoff zu Mehrfach-Kabelverschraubungen

Synthetic locking pins for multi-duct cable glands

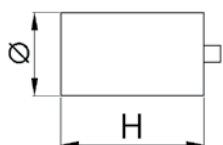

Material: Polyamid PA 6
 Einsatztemperatur: -30°C / +100°C
 Einsatzbereich: Zum Verschliessen nicht belegter Bohrungen in Mehrfach-Kabelverschraubungen

Material: Polyamide PA 6
 Temperature range: -30°C / +100°C
 Application: Usable as inserts to close unused holes in sealings of multi-duct cable glands

Verschlussbolzen zu Kabelverschraubungen

Locking pins for cable glands



Art.-Nr.	$>\varnothing<$ mm	H mm	
1310.030.07	3	14	50
1310.050.07	5	14	50
1310.070.07	7	14	50
1310.090.07	9	14	50

Einschnittringe NBR passend zu Stopfbuchsen B 107- B 263

Sealing rings NBR suitable for cable gland B 107 - B 263

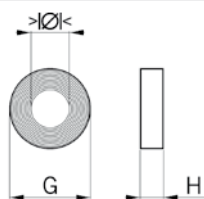

Material: NBR
 Einsatztemperatur: -20°C / +100°C
 Einsatzbereich: Passend zu Stopfbuchsen B107 - B263

Material: NBR
 Temperature range: -20°C / +100°C
 Application: Suitable for cable glands series B107 - B263



Art.-Nr.	G	$>\varnothing<$ mm	H mm	
B 107.00.03	M12 / Pg 7	4.0-7.0	5.0	1
B 109.00.03	M16 / Pg 9	5.0-10.0	5.5	1
B 111.00.03	Pg 11	8.0-12.0	6.0	1
B 113.00.03	Pg 13	8.0-12.0	6.0	1
B 116.00.03	M20 / Pg 16	8.0-15.0	7.0	1
B 121.00.03	M25 / Pg 21	10.0-19.0	8.0	1
B 129.00.03	M32 / Pg 29	18.0-27.0	9.5	1
B 136.00.03	M40 / Pg 36	24.0-33.0	12.0	1
B 142.00.03	M50 / Pg 42	30.0-39.0	14.0	1
B 148.00.03	M63 / Pg 48	36.0-45.0	14.0	1

Spezialwerkzeug

bei geringem Platzbedarf

Special tool

for cramped confines

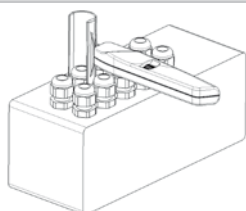



Einsatzbereich: Montagewerkzeug für Kabelverschraubungen bei engsten Platzverhältnissen
 Eigenschaften: Nur 2 Werkzeuge für Schlüsselweiten von 11 bis 36 mm notwendig, Zeitersparnis durch Ratschenfunktion

Application: Assembly tool for cable glands under cramped confines
 Properties: Only 2 tools necessary for wrench sizes from 11 to 36 mm, time saving due to the rattle function



verstellbare Schlüsselweiten

adjustable wrench sizes

Art.-Nr.	 mm	L mm	B mm	
4800.24	11-24	190	60	1
4800.36	24-36	204	60	1